

BEGINNING SHEET

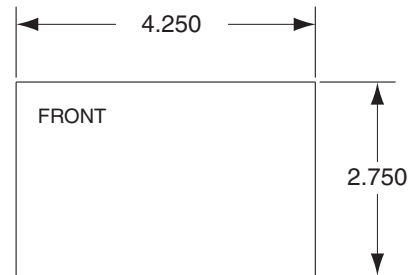

FOLDED SHEET

Additional Notes:
None

Revision History						Revision Description:					
A	B	C	D	E	F	B > Rebranding					
018869	023215	EC#	EC#	EC #	EC #						
Material						Edited By		Approved By		EC Number	Release Date
White Paper						R. Byun		M. Roberts		023215	3-01-2012
Notes						Title					
<ol style="list-style-type: none"> printed two sides printed black tolerance: ± .13 see sheet 2 for artwork printed in country may vary drawings not to scale 						RP100 IS					
Creation Date			Number			Revision					
06-30-2011			P516-364			B					
Created By			Activity			Schlage Lock Company			Copyright © 2012		
S. Bieker			3899 Hancock Expwy			Security, CO 80911					
Software: Illustrator CS4											



P516-364



NEXIA™
HOME INTELLIGENCE

RP100

**Home Appliance Module and
Home Dimmer Module**



The RP100 Home Appliance Module works with the Nexia Home Intelligence system as both a lighting or small appliance controller and a signal repeater to help extend the range of the Nexia Home Intelligence bridge.

⚠ WARNING

FOR INDOOR USE ONLY!

FAILURE TO FOLLOW THIS WARNING MAY RESULT IN PROPERTY DAMAGE, PERSONAL INJURY OR DEATH.

The device plugged into the Z-Wave™ controlled outlet on this module must not exceed 600 watts (incandescent); 1800W (15A) Resistive or ½ HP Motor. Total load capacity for both outlets is 1800W Resistive.

To reduce the risk of electric shock, this product has a grounding type plug that has a third (grounding) pin. This plug will only fit into a grounding type power outlet. If the plug does not fit into the outlet, contact a qualified electrician to install the proper outlet. Do not change the plug in any way.

Any modification or use other than described may damage the unit and will void the warranty.

For warranty details, go to nexiahome.com and click Service & Support, or call Customer Service at 877-288-7707.

Specifications

Power 120VAC, 60Hz

Signal (Frequency) 908.42 MHz

Maximum load for both outlets 15 Amps, 1800W Resistive

Maximum load for the Z-Wave controlled outlet: 600W

Incandescent, ½ HP Motor or 1800W Resistive

Range: Up to 100 feet line of sight between the Wireless Controller and the closest Z-Wave receiver module.

Operating Temperature Range: 32-104° F (0-40° C)

For indoor use only.

Specifications subject to change without notice due to continuing product improvement

FCC NOTICE

U2Z45602-3

The Federal Communication Commission Radio Frequency Interference Statement includes the following paragraph: The equipment has been tested and found to comply with the limits for a Class B Digital Device, pursuant to part 15 of the FCC Rules. These limits are designed to provide reasonable protection against harmful interference in a residential installation. This equipment uses, generates and can radiate radio frequency energy and, if not installed and used in accordance with the instruction, may cause harmful interference to radio communication. However, there is no guarantee that interference will not occur in a particular installation. If this equipment does cause harmful interference to radio or television reception, which can be determined by turning the equipment off and on, the user is encouraged to try to correct the interference by one or more of the following measures:

- Reorient or relocate the receiving antenna
- Increase the separation between the equipment and receiver
- Connect the equipment into an outlet on a circuit different from that to which the receiver is connected
- Consult the dealer or an experienced radio/TV technician for help

Operation is subject to the following two conditions:

- This device may not cause interference and
- This device must accept any interference, including interference that may cause undesired operation of the device.

Important Note: To comply with the FCC RF exposure compliance requirements, no change to the antenna or the device is permitted. Any change to the antenna or the device could result in the device exceeding the RF exposure requirements and void user's authority to operate the device.

IC NOTICE

Compliance with IC Rules and Regulations

IC: 6924A-45602A3

Jasco Products Company

Model: 45603

ZW4101

This Class B digital device complies with Canadian ICES-003.

Controlling Appliances

⚠ WARNING

NOT FOR USE WITH MEDICAL OR LIFE SUPPORT EQUIPMENT

FAILURE TO FOLLOW THIS WARNING MAY RESULT IN PERSONAL INJURY OR DEATH.

Z-Wave enabled devices should never be used to supply power to or control the On/Off status of medical or life support equipment.

⚠ WARNING

DO NOT USE Z-WAVE DEVICES (Home Appliance Module) TO CONTROL ELECTRIC HEATERS OR ANY OTHER APPLIANCES WHICH MAY PRESENT A HAZARDOUS CONDITION.

FAILURE TO FOLLOW THIS WARNING MAY RESULT IN PROPERTY DAMAGE, PERSONAL INJURY OR DEATH.

Exercise extreme caution when using Z-Wave devices to control appliances. Z-Wave devices may automatically be powered on due to timed event programming. Depending on the appliance, an unintended or unintentional "power on" operation may result in a hazardous condition.

Customer Service:

(877) 288-7707 (U.S.A. /Canada)

Warranty information is available at www.nexiahome.com.

1 Installation

1. Plug the home appliance module into any available outlet.
 - Use any indoor, three-prong, 120 volt A/C outlet.
2. (Optional) Plug a lamp (incandescent or CFL) or small appliance into the Z-Wave™ side of the home appliance module.
 - There are two outlets on the home appliance module. One of the outlets is labelled with a Z-Wave™ logo. A lamp or small appliance can be controlled by the system if it is plugged into the Z-Wave™ side of the appliance module.
 - The other outlet can be used simply as a pass-through outlet (1800 watts maximum total for both outlets). It is not controlled by the system, and the system is not affected when it is used.

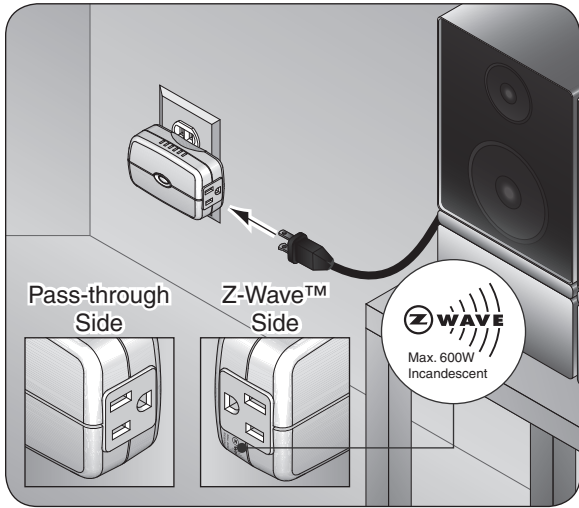

2 Enrollment

1. Enroll the home dimmer module into the bridge.
 - a. Disconnect power and Ethernet from the bridge.
 - b. Install a fresh 9-volt battery into the bridge.
 - c. Hold the bridge within 6 feet (1.8 meters) of the appliance module throughout enrollment.
 - d. Press and release the plus (+) button on the bridge.
 - e. Double-click the button on the appliance module.
 - f. Observe the lights on the bridge. The orange light will blink while enrollment is taking place. Enrollment is complete when the orange light becomes solid.
 - g. Reconnect power and Ethernet to the bridge.

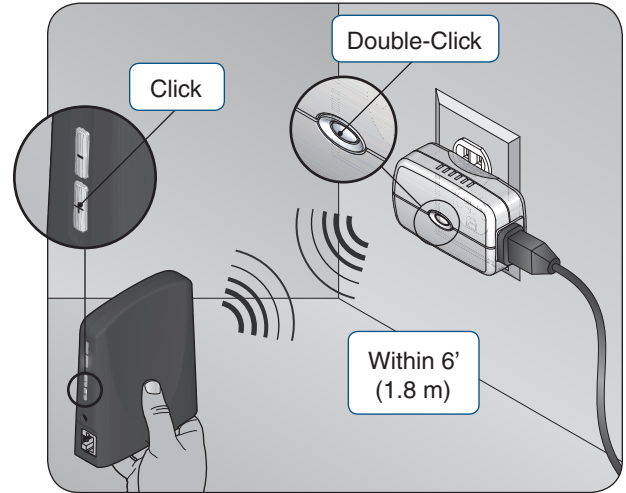

3 Remote Control

- Log into your account at www.mynexia.com. Click the Lighting & Automation tab. The appliance module will be displayed.
- Optional: If using the Nexia Home Intelligence mobile application, then click MY PHONES, EDIT PHONE, and check the box to control the home appliance module with your mobile device.

4 Manual Operation

- Press the button once to turn the light/appliance on or off.